

XZCC8FCM40V

Female, M8, 4 pin, elbowed connector, cable gland M9.5 x 1

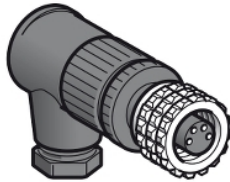

Main

Range of product	Telemecanique Cabling components
Accessory / separate part category	Cabling accessories
Accessory / separate part type	Connector
Electrical connection	Elbowed female connector M8, 4 pins
Collar material	Metal
Status LED	Without
Cable connection	Vampire clip / wire size <0.25 mm ² / clamping capacity 5 mm

Complementary

Cable gland type	M9.5
Cable connector fixing	Screw-on
[Ue] rated operational voltage	60 V AC 75 V DC
[In] rated current	4 A
Enclosure material	Plastic
Minimum insulating resistance	1 GΩ
Contact resistance	10000 μOhm
Net weight	0.01 kg

Environment

IP degree of protection	IP67
Ambient air temperature for operation	-25...70 °C

Packing Units

Unit Type of Package 1	PCE
Number of Units in Package 1	1
Package 1 Height	1.8 cm
Package 1 Width	9.0 cm
Package 1 Length	11.5 cm
Package 1 Weight	14.0 g
Unit Type of Package 2	S01
Number of Units in Package 2	50
Package 2 Height	15.0 cm
Package 2 Width	15.0 cm
Package 2 Length	40.0 cm
Package 2 Weight	988.0 g

Offer Sustainability

California proposition 65	WARNING: This product can expose you to chemicals including: Diisononyl phthalate (DINP), which is known to the State of California to cause cancer, and Di-isodecyl phthalate (DIDP), which is known to the State of California to cause birth defects or other reproductive harm. For more information go to www.P65Warnings.ca.gov
For all Reach Rohs enquiries contact us at	sustainability@tesensors.com

Contractual warranty

Warranty	18 months
----------	-----------

Dimensions

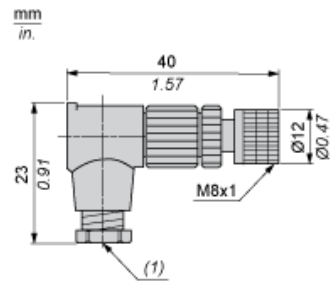

(1) Cable gland : M9.5 x 1

Connections and Schemes

